

World Class Design for Light Industrial and Instrumentation Applications



16 mm
800B



LISTEN.
THINK.
SOLVE.®

SUPERIOR DESIGN

The Allen-Bradley Bulletin 800B 16 mm Push Button line can meet your light industrial and instrumentation application needs with its highly configurable and flexible design. Excellent for applications with limited panel space or a small footprint. This bold and bright line of Push Buttons is a smart choice for you.

WORLDWIDE SOLUTIONS

- Designed to worldwide standards



DURABLE MATERIALS

- Bulletin 800B operators are made of corrosion-proof plastic to ensure long push button life
- Consistent coloring and illumination make these easy to identify for the life of the operator

EASE OF INSTALLATION

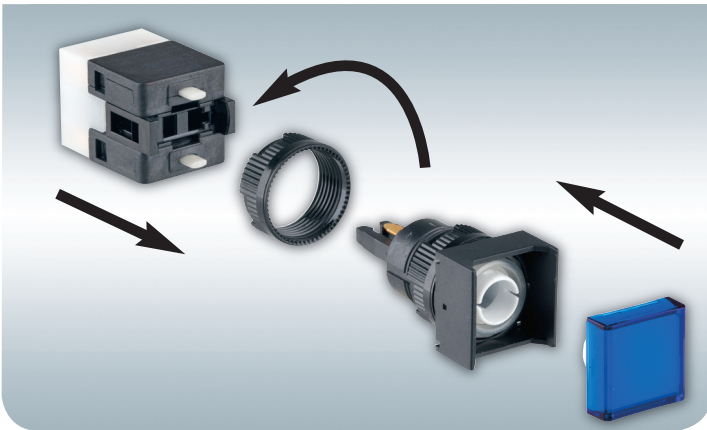

ERGONOMIC DESIGN



- Bright, bold, consistent operators are easy to see
- Contoured button surface for comfort
- Operator diffusers available with custom markings

DEPENDABLE SEALING



- IP66 and Type 4/13
- Diaphragm seals
 - Linear travel devices
 - Pilot Lights
- V-seals
 - Selector Switches
 - High pressure sealing
- K-seals
 - Emergency Stops
 - Dual wiping action

RELIABLE LOW VOLTAGE SWITCHING

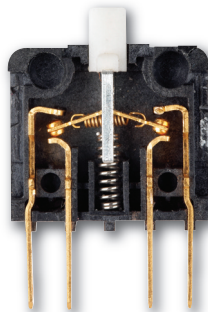

- Gold-plated snap action contacts
- Reliability operation in applications below 24V DC, 5 mA down to 5V DC, 1 mA

ENHANCED E-STOP FUNCTIONALITY

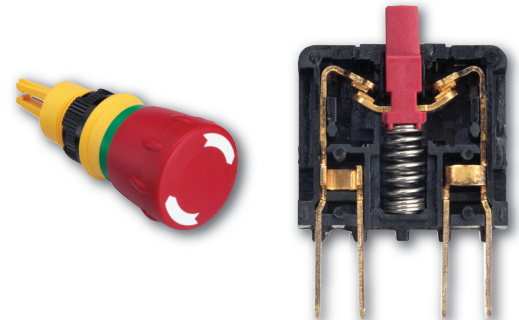

- Anti-tease feature standard
 - Trigger-action design
- EN13850 and EN 60947-5-5 compliant
- Direct Drive mechanism
 - Positive actuation
- Slow make/break

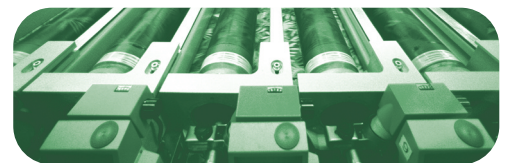

For a full product offering, please refer to the Industrial Controls catalog or contact your local Rockwell Automation sales office or Allen-Bradley distributor. You can also visit our website at: www.ab.com/components.

PUSH BUTTON OPERATORS

MOMENTARY PUSH BUTTON / PILOT LIGHT OPERATORS

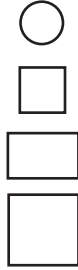

EXTENDED
800B-EPA

800B-EPB

800B-EPC

800B-EPD

ROUND

SQUARE

RECTANGLE

LARGE SQUARE

FLUSH

800B-FPA

800B-FPB

800B-FPC

MAINTAINED PUSH BUTTON OPERATORS



800B-EAA

800B-EAB

800B-EAC

800B-EAD

ROUND

SQUARE

RECTANGLE

LARGE SQUARE

2-POSITION SELECTOR SWITCH OPERATORS



800B-SM2A

800B-SR2A

800B-KM2A

800B-KR2A

MAINTAINED

RETURN FROM RIGHT

KEYED, MAINTAINED

KEYED, RETURN FROM RIGHT

3-POSITION SELECTOR SWITCH OPERATORS



800B-SM3A

800B-SB3A

800B-KM3A

800B-KB3A

MAINTAINED

RETURN FROM BOTH

KEYED, MAINTAINED

KEYED, RETURN FROM BOTH

EMERGENCY STOP OPERATORS



800B-MT

NON-ILLUMINATED



LENS CAP WITH DIFFUSER

GREEN



RED



YELLOW



BLUE



WHITE



BEZEL FOR ROUND OPERATORS

SQUARE



RECTANGLE

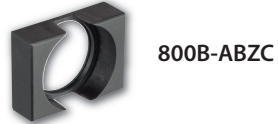

LARGE SQUARE

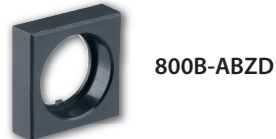

CONTACT BLOCK/LATCH MODULE

PUSH BUTTON/SELECTOR SWITCH

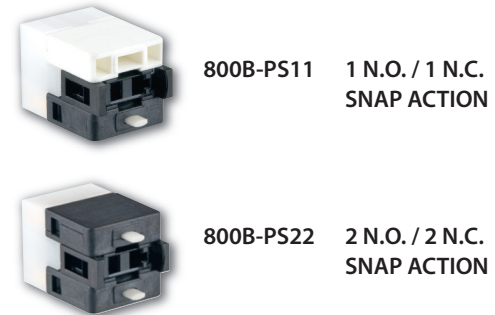



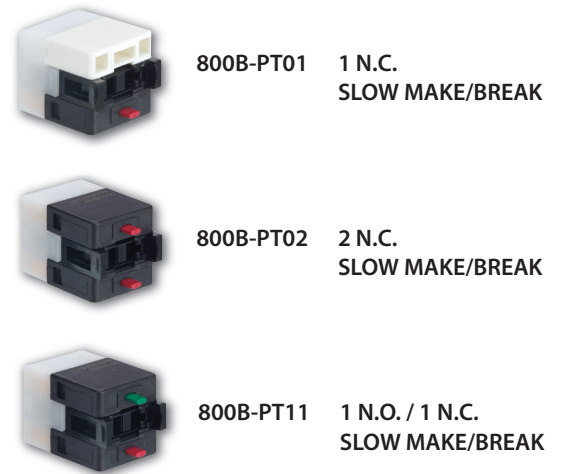

EMERGENCY STOP/PUSH BUTTON/SELECTOR SWITCH



PILOT LIGHT



ILLUMINATION

LED BULB	6V AC/DC	12V AC/DC	24V AC/DC	120V AC
	N/A	800B-N3G		800B-N5G
	N/A	800B-N3R		800B-N5R
	N/A	800B-N3W		800B-N5W
INCANDESCENT BULB	6V AC/DC	12V AC/DC	24V AC/DC	120V AC
	800B-N1C	800B-N2C	800B-N3C	N/A

OPERATOR ASSEMBLY SEQUENCE

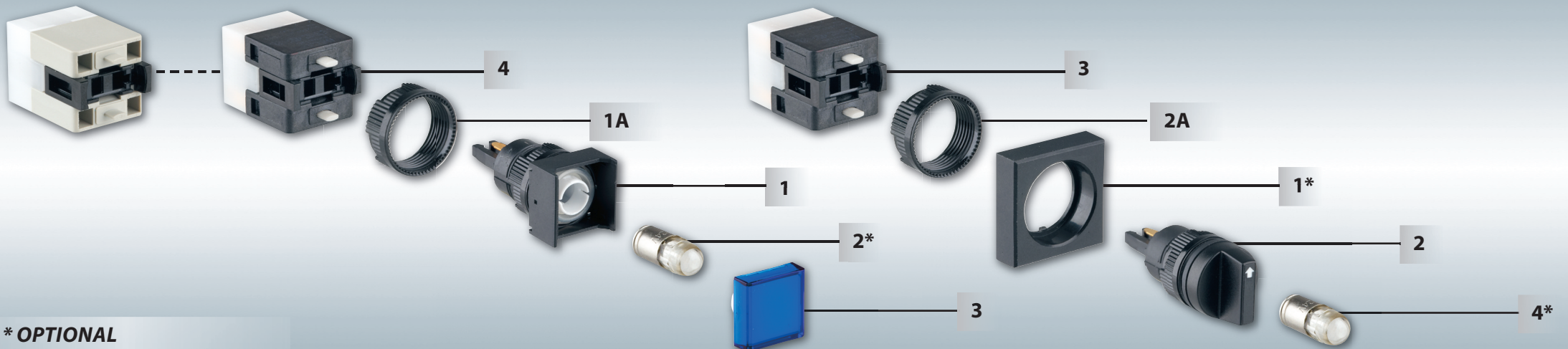

* OPTIONAL

ACCESSORIES

REPLACEMENT MOUNTING RING



800B-ARP

STAB CONNECTOR (INSULATED)



800B-ATK

MOUNTING RING WRENCH



800B-AW2

HOLE PLUG



800B-N2

BULB REMOVAL TOOL



800B-ALR1

REPLACEMENT KEY



800B-AK1

LOCKING WASHER (ANTI-ROTATION)



800B-ALW1

PRINTED CIRCUIT BOARD PIN SOCKET



800B-APCB

LENS REMOVAL TOOL



800B-ALR2

LASER-ENGRAVED DIFFUSER

800B-AD a b (Ex. 800B-ADBCE100J)

a	b		
	CE100H	CE100J	CU100
A			
B			
C			
D			

EMERGENCY STOP LEGEND PLATE



800B-15YE112



800B-15Y

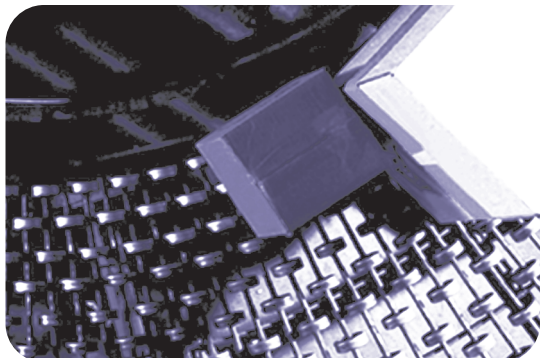

SPECIFICATIONS

MECHANICAL RATINGS – OPERATOR

Vibration (assembled to panel)	Tested at 10...2000 Hz, 1.52 mm displacement (peak-to-peak) max./10 G max. for 6 hr duration, no damage	
Shock	Tested at 1/2 cycle sine wave for 11 ms; no damage at 100 G	
Degree of protection	IP66, Type 4/4X/13	
Mechanical durability per EN 60947-5-1 (Annex C)	Push buttons – momentary	2000000
	Push buttons – maintained	1000000
	Selector switch	250000
	Key selector switch	200000
	Twist-to-release E-stop	100000
Operating forces (typical with one contact block)	Extended	5...8 N
	E-stop	20 N
Operating torque (typical application with one contact block)	Selector switch = 0.06 N·m (0.5 lb-in)	
Mounting torque	1.1 N·m (10 lb-in)	

ENVIRONMENTAL

Temperature range (operating)	UL Recognition: Illuminated operators Pilot lights	-25...+50 °C (-13...131 °F) with LED bulbs -25...+50 °C with incandescent bulbs -25...+70 °C (-13...158 °F) with LED bulbs
Temperature range (short term storage)	-40...+70 °C (-40...158 °F)	
Humidity	50...95% RH from 25...60 °C (77...140 °F)	

PRODUCT CERTIFICATIONS

Certifications	UR/UL, CSA, CCC, CE
Standards compliance	UL 508, EN ISO 13850, EN 60947-1, EN 60947-5-1, EN 60947-5-5
Terminal identification	EN/IEC 60947-1
RoHS Compliant	Yes

MECHANICAL RATINGS – CONTACT BLOCK

Vibration (assembled to panel)	Tested at 10...2000 Hz, 1.52 mm displacement (peak-to-peak) max./10 G max. 6 hr	
Shock	Tested at 1/2 cycle sine wave for 11 ms and no damage at 100 G max.	
Contact durability per EN 60947-5-1 (Annex C)	200000 cycles	
Contact operation	N.O. / N.C. N.C. N.O.	Snap action Slow make/break Slow make/break
Push button travel to change electrical state	1.4 mm (0.06 in.)	
Operating forces (typical)	1 contact block	3 N
	2 contact blocks	6 N

ELECTRICAL RATINGS

Standard contact block ratings	AC 15, B300, 1.5 A/240V AC, 3 A/120V AC DC 13, R300, 0.1 A/250V DC, 0.22 A/125V DC		
LED Module ratings	Nominal Voltage	Current	Frequency
	12...24V AC	11 mA	50/60 Hz
	12...24V DC	11 mA	DC
	120V AC	7 mA/8 mA	50/60 Hz
	12...24V AC/DC LED bulbs: 2 mA current resistance, DC polarity insensitive		
Thermal current	$I_{th} = 5 \text{ A (AC)}, I_{th} = 1 \text{ A (DC)}$		
Insulation voltage (U_i)	300V		
Stab termination	2.8 X 0.5 mm		
Dielectric strength (minimum)	1500V 1 min.		
External short circuit protection – standard blocks	5 A type gL/gG cartridge fuse to EN 60269-2-1 or gN (Class J to UL 248-8 or Class C to UL 248-4)		
Electrical shock protection	Finger-safe conforming to IP2X		

ILLUMINATION

LED Dominant wavelength	Green Red White	525 nm 624 nm —
LED Luminous intensity	Green Red White	500 mcd 400 mcd 1000 mcd
Incandescent maximum wattage	1.2 W	

MATERIALS

Springs	Stainless steel and high-carbon steel – music wire
Electrical contacts	Gold-plated silver
Stab terminals	Phosphor bronze with gold or tin plating
Lenses	Acrylic

APPROXIMATE DIMENSIONS

ROUND

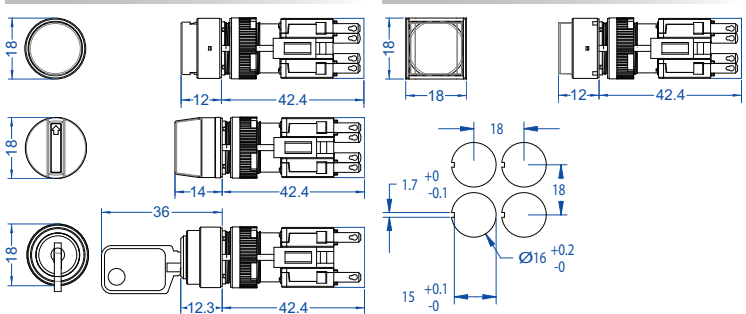

SQUARE

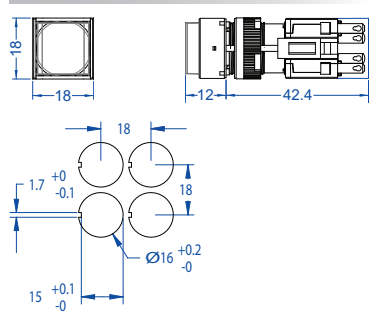

RECTANGLE

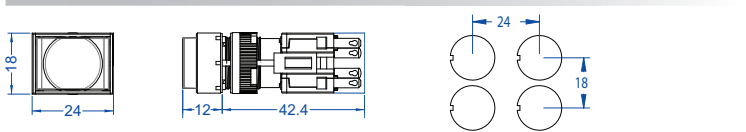

LARGE SQUARE

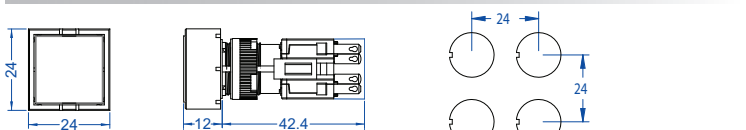

EMERGENCY STOP

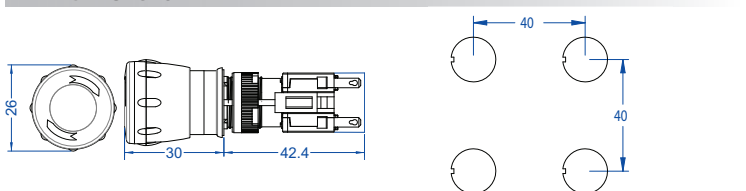

Rockwell Automation offers a breadth of quality Allen-Bradley® components to fit your specific needs. In order to assist you with your component selection, we offer a variety of configuration and selection tools.



Local Distributor

Call 1.800.223.3354 to contact your local Distributor today.
<http://www.rockwellautomation.com/distributor/>



On-Line Product Directory

Our extensive product portfolio is designed to improve your processes through every stage of your manufacturing cycle.
<http://www.rockwellautomation.com/products/>



Product Selection Toolbox

Our powerful range of product selection and system configuration tools assist you in choosing and applying our products.
<http://www.rockwellautomation.com/en-e-tools/>



Catalogs

Within our catalogs you'll find an extensive selection of essential Allen-Bradley component products.
<http://www.ab.com/catalogs/>

www.rockwellautomation.com

Power, Control and Information Solutions Headquarters

Americas: Rockwell Automation, 1201 South Second Street, Milwaukee, WI 53204-2496 USA, Tel: (1) 414.382.2000, Fax: (1) 414.382.4444

Europe/Middle East/Africa: Rockwell Automation NV, Pegasus Park, De Kleerlaan 12a, 1831 Diegem, Belgium, Tel: (32) 2 663 0600, Fax: (32) 2 663 0640

Asia Pacific: Rockwell Automation, Level 14, Core F, Cyberport 3, 100 Cyberport Road, Hong Kong, Tel: (852) 2887 4788, Fax: (852) 2508 1846