

MINIATURE FITTINGS: M3, M5, 1/8

- ✓ Compact and space saving
- ✓ Tube has a large retaining force
- ✓ Hose nipple assures easy removal
- ✓ Accepts nylon tubes, soft nylon tube and polyurethane



PRODUCT
SELECTOR

MANIFOLD:
M-5M

PRODUCT
SELECTOR

BARB FITTING FOR SOFT TUBE:
M-3AU-4
M-5AU-4
M-5AU-6



PRODUCT
SELECTOR

BARB ELBOW FOR SOFT TUBE:
M-3ALU-4
M-5ALU-6



PRODUCT
SELECTOR

UNIVERSAL ELBOW:
M-3UL
M-5UL



1/8 female diverted
to 9 x M5

PRODUCT
SELECTOR

UNIVERSAL TEE:
M-3UT
M-5UT



PRODUCT
SELECTOR

NIPPLE:
M-3N
M-5N



PRODUCT
SELECTOR

PLUG:
M-3P
M-5P



PRODUCT
SELECTOR

GASKET:

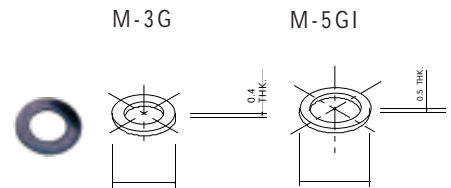

MORE SELECTIONS
SEE NEXT PAGE

HOW TO
ORDER
SEE NEXT PAGE

PRODUCT
SELECTOR

HOSE NIPPLE:
M-5H-4
M-5H-6



PRODUCT
SELECTOR

ELBOW:
M-5L



PRODUCT
SELECTOR

HOSE ELBOW:
M-5HL-4
M-5HL-6



Uses Gasket M-5GH

PRODUCT
SELECTOR

GASKET:
M-5GH

Similar to Picture
M-3G (above)
Use with M-5HL

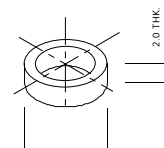

PRODUCT
SELECTOR

TEE:
M-5T



FOR FURTHER TECHNICAL
DETAILS ON THIS
PRODUCT REQUEST
CATALOGUE REFERENCE
E501

TUBE FITTINGS: MINIATURE

PRODUCT
SELECTOR

EXTENSION FITTING:
M-5J



PRODUCT
SELECTOR

UNIVERSAL NIPPLE:
M-5UN



PRODUCT
SELECTOR

BULKHEAD:
M-5E



PRODUCT
SELECTOR

BULKHEAD REDUCER:
M-5ER



M5 female to 1/8 female taper

PRODUCT
SELECTOR

REDUCING BUSHING:
M-5B



M5 female to 1/8 male taper

PRODUCT
SELECTOR

STRAIGHT ADAPTOR:
M-01H-4
M-01H-6



PRODUCT
SELECTOR

STRAIGHT BARB CONNECTOR:
M-01AU-4
M-01AU-6



TECHNICAL
SPECIFICATIONS

Applicable tube material		Nylon	Soft nylon	Polyurethane
Applicable tube dia* OD/ID (mm)	M3	—	ø4/ø2.5	ø4/ø2.5
	M5 1/8	ø4/ø2.5 ø6/ø4	ø4/ø2.5 ø6/ø4	ø4/ø2.5, ø6/ø4
Max operating pressure		10 Bar	8 Bar	5 Bar
Port size		M3, M5, 1/8		
Thread		JIS B0209 class 2 (Metric coarse thread), JIS B0203 (Taper pipe thread)		

*Dimensions to BS5409 Part 1

HOW TO
ORDER
MINIATURE FITTINGS

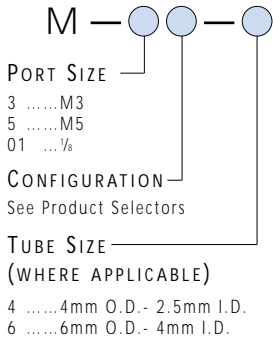

PRODUCT
SELECTOR

MALE/MALE NIPPLE:
NIPPLE 1/8
NIPPLE 1/4
NIPPLE 3/8
NIPPLE 1/2
NIPPLE 3/4



PRODUCT
SELECTOR

FLUSH TAPER PLUGS:
1/8, 1/4, 3/8, 1/2, 3/4



HOW TO
ORDER
MALE/MALE NIPPLE

- 1/8 NIPPLE 1/8-1/8
- 1/4 NIPPLE 1/4-1/4
- 3/8 NIPPLE 3/8-3/8
- 1/2 NIPPLE 1/2-1/2
- 3/4 NIPPLE 3/4-3/4

HOW TO
ORDER
FLUSH TAPER PLUGS:

- 1/8 PLUG 1/8
- 1/4 PLUG 1/4
- 3/8 PLUG 3/8
- 1/2 PLUG 1/2

STOCKED PRODUCTS
FOR A LIST OF STOCKED PRODUCTS,
PLEASE SEE THE CURRENT SMC PRICE LIST



SEE INSIDE FRONT COVER FOR
DETAILS OF YOUR LOCAL SALES OFFICE



FOR FURTHER TECHNICAL
DETAILS ON THIS
PRODUCT REQUEST
CATALOGUE REFERENCE
E501

ONE-TOUCH MINI FITTINGS SERIES KJ

- ✔ For use with SMC miniature valves and actuators. M3 & M5 ported
- ✔ Compact one-touch collet design allows easy dis-assembly with strong tube gripping
- ✔ For use from 10 Torr vacuum to 10 bar pressure
- ✔ Electroless nickel plated as standard

TECHNICAL SPECIFICATIONS

Fluid Air
 Max operating pressure 9.9kgf/cm² (990kPa)
 Operating vacuum pressure 10 Torr-
 Ambient and fluid temperature ... 0-60°C
 Thread Thread portion JISB0211, class 2 (Metric coarse thread)
 Nut JISB0211, class 2 (Metric fine thread)
 Seal Nut Flat gasket
 Possible to use joint avoiding copper material C3604BD component, with electroless nickel plating



PRODUCT SELECTOR

MALE CONNECTOR: KJH

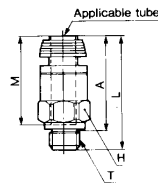

Applicable tube O.D (mm)	Thread T	Model	H (Hex)	L	A	M	Effective orifice (mm ²)	Weight (gf)
4	M3x0.5	KJH04-M3	8	18	15.5	14.5	0.9	1.9
4	M5x0.8	KJH04-M5	8	18.5	15.5	14.5	4	2.4
6	M5x0.8	KJH06-M5	10	20	16.5	15.5	4	3.4

PRODUCT SELECTOR

EXTENDED MALE ELBOW: KJW

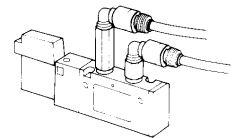
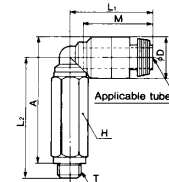

Applicable tube O.D (mm)	Thread T	Model	H (Hex)	ØD	L1	L2	A orifice (mm ²)	M (gf)	Effective (gf)	Weight
4	M3x0.5	KJW04-M3	7	8.9	17.5	23	25	14.5	0.8	5
4	M5x0.8	KJW04-M5	7	8.9	17.5	25.5	27	14.5	3.5	6.4
6	M5x0.8	KJW06-M5	7	11	17.5	26.5	29	15.5	3.5	6.9

PRODUCT SELECTOR

HEXAGON SOCKET HEAD MALE CONNECTOR: KJS

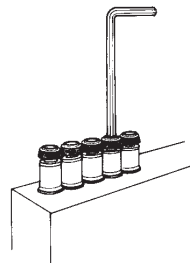
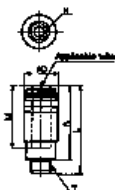

Applicable tube O.D (mm)	Thread T	Model	H (Hex)	ØD	L	A	M orifice (mm ²)	Effective (gf)	Weight
4	M3x0.5	KJS04-M3	1.5	8	18	15.5	14.5	1.4	1.5
4	M5x0.8	KJS04-M5	2.5	8	20.5	17	14.5	4	2.6
6	M5x0.8	KJS06-M5	2.5	10	21.5	18	15.5	4	3.2

PRODUCT SELECTOR

FEMALE UNION: KJF

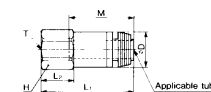

Applicable tube O.D (mm)	Thread T	Model	H (Hex)	ØD	L	A	M orifice (mm ²)	Effective (gf)	Weight
4	M3x0.5	KJF04-M3	8	8	18	5.5	14.5	4	3.2
4	M5x0.8	KJF04-M5	8	8	20.5	7.5	14.5	4	3.8
6	M5x0.8	KJF06-M5	10	10	20	7	15.5	10	5.1

MORE SELECTIONS SEE NEXT PAGE

HOW TO ORDER SEE NEXT PAGE

PRODUCT
SELECTOR

MALE ELBOW:
KJL

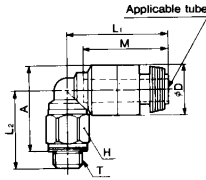

Applicable tube O.D (mm)	Thread T	Model	H (Hex)	ØD	L1	L2	A orifice (mm ²)	M	Effective Weight (gf)
4	M3x0.5	KJL04-M3	7	8.9	17.5	13	15	14.5	0.8
4	M5x0.8	KJL04-M5	7	8.9	17.5	13.5	15	14.5	3.5
6	M5x0.8	KJL06-M5	7	11	17.5	14.5	17	15.5	3.5

PRODUCT
SELECTOR

BRANCH TEE:
KJT

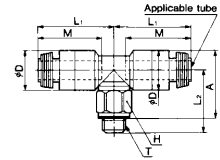

Applicable tube O.D (mm)	Thread T	Model	H (Hex)	ØD	L1	L2	A orifice (mm ²)	M	Effective Weight (gf)
4	M3x0.5	KJT04-M3	7	8.9	17	13.5	15.5	14.5	0.9
4	M5x0.8	KJT04-M5	7	8.9	17	14	15.5	14.5	4.5
6	M5x0.8	KJT06-M5	7	11	17.5	15	17.5	15.5	4.5

PRODUCT
SELECTOR

MALE RUN TEE:
KJY

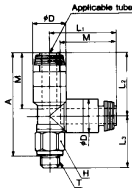

Applicable tube O.D (mm)	Thread T	Model	H (Hex)	ØD	L1	L2	L3	A	M	Effective orifice (mm ²)	Weight (gf)
4	M3x0.5	KJY04-M3	7	8.9	17.5	16.5	13	27	14.5	0.9	3.1
4	M5x0.8	KJY04-M5	7	8.9	17.5	16.5	13.5	27	14.5	4.5	3.5
6	M5x0.8	KJY06-M5	7	11	19	19	14.5	30.5	15.5	4.5	4.3

HOW TO
ORDER
SERIES KJ



CONFIGURATION

- FFemale
- HStraight
- LElbow
- TTee
- SAllen Socket
- WExtended Elbow
- YRun Tee

TUBE O. D.

- 04 ...Ø4mm
- 06 ...Ø6mm

CONNECTION THREAD

- M3 ...M3x0.5mm (Ø4mm pipe only)
- M5 ...M5x0.8mm

STOCKED PRODUCTS

FOR A LIST OF STOCKED PRODUCTS,
PLEASE SEE THE CURRENT SMC PRICE LIST



SEE INSIDE FRONT COVER FOR
DETAILS OF YOUR LOCAL SALES OFFICE



FOR FURTHER TECHNICAL
DETAILS ON THIS
PRODUCT REQUEST
CATALOGUE REFERENCE
E501